

DETAILS

Product Number	C10891_GT3-S
Family	Gt3
Type	Lens array
Color	clear
Diameter	35 mm
Height	9 mm
Style	round
Optic Material	PMMA
Holder Material	
Fastening	glue, pin
Status	production ready
ROHS Compliant	Yes
Date Updated	10/11/2014



OPTICAL PROPERTIES

LED	Viewing Angle	Light Beam	Efficiency	cd/lm	Connector
XP-E	14 deg	Spot	92 %	8.400	-
XP-G	21 deg	Spot	92 %	4.560	-
XB-D	14 deg	Spot	92 %	4.300	-
LUXEON Rebel ES	21 deg	Spot	89 %	-	-
LUXEON Rebel	16 deg	Spot	91 %	-	-
LUXEON A	21 deg	Spot	-	-	-
NCSxx19A	14 deg	Spot	88 %	-	-
NVSxx19A	17 deg	Spot	88 %	-	-
Oslon SSL 150	22 deg	Spot	86 %	3.560	-
Oslon SSL 80	17 deg	Spot	92 %	-	-
Oslon Square EC	26 deg	Spot	90 %	2.150	-
Z5	14 deg	Spot	-	-	-
Double Dome (GM2BB)	18 deg	Spot	-	-	-

Relative intensity of

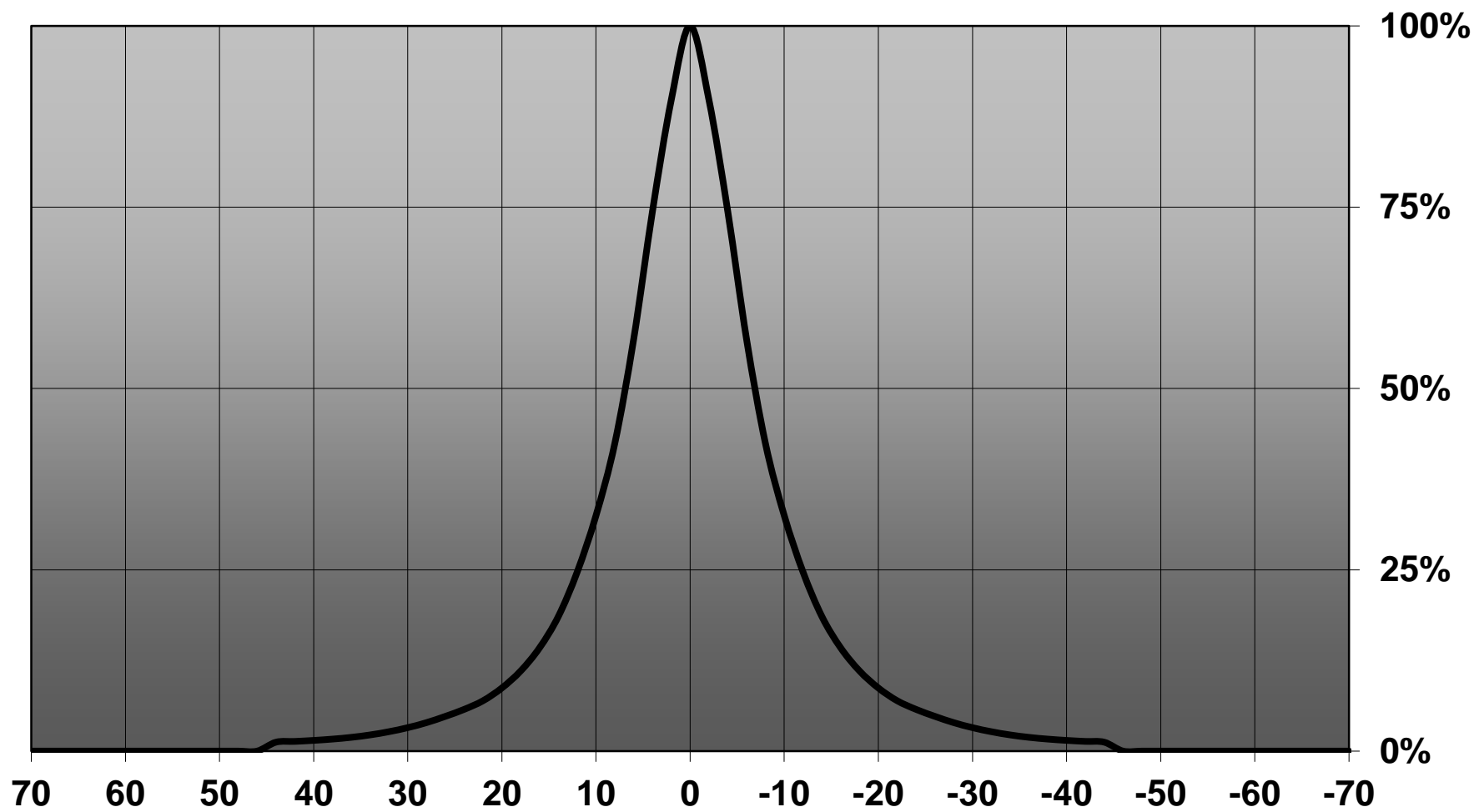

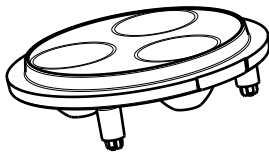

Isometric view
Scale: 1:1

Material: PMMA

Part no.s:

- C10891_GT3-XP-S
- C10891_GT3-XP-G-S
- C10891_GT3-OSL-S
- C10891_GT3-DD-S
- C10891_GT3-RE-ES-M
- C10891_GT3-Z5-S
- C10892_GT3-XP-M
- C10892_GT3-XP-G-M
- C10892_GT3-OSL-M
- C10892_GT3-DD-M
- C10892_GT3-XP-M
- C10892_GT3-Z5-M
- C10893_GT3-XP-W
- C10893_GT3-XP-G-W
- C10893_GT3-OSL-W
- C10893_GT3-DD-W
- C10893_GT3-RE-ES-W
- C11623_GT3-RE-VW
- C11623_GT3-N19-VW
- C11624_GT3-XP-VW
- C11624_GT3-XP-G-VW
- C11624_GT3-OSL-VW
- C11624_GT3-DD-VW
- C11624_GT3-Z5-VW

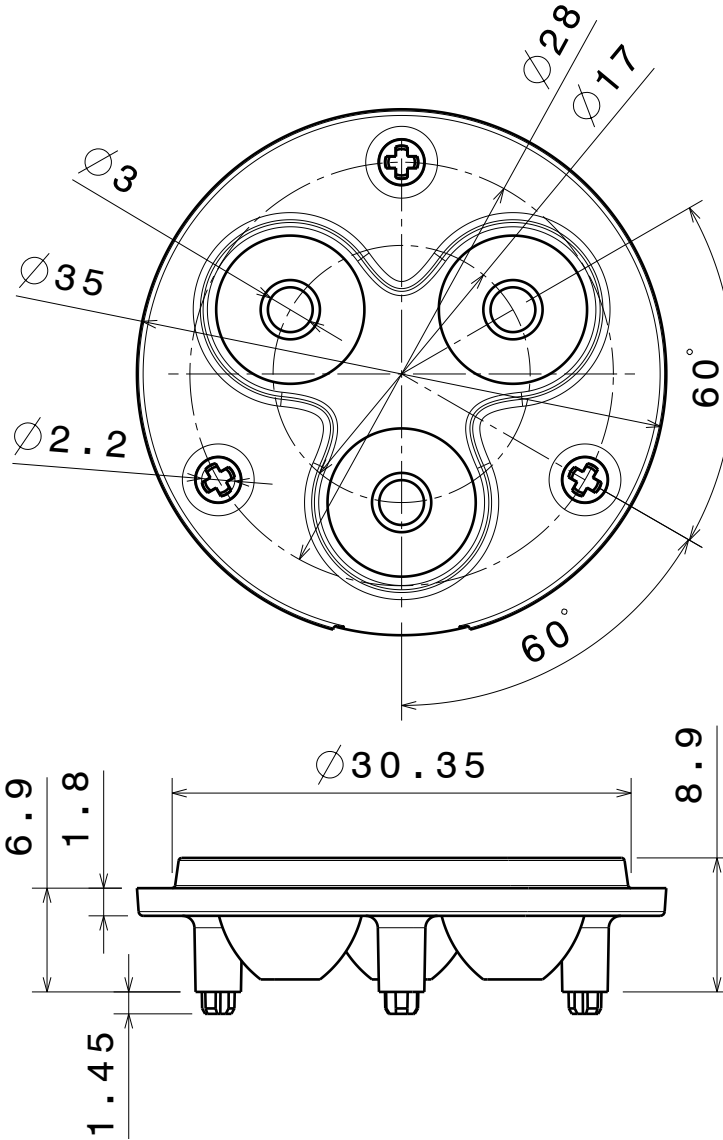

Bottom view

Front view

This drawing is our property.
It can't be reproduced
or communicated without
our written agreement.



L
T
F
F

e
e
i
i
N
n

DRAWING TITLE

Datasheet GT3-Series Lens

DRAWN BY p		DATE 08.01.2010		DRAWING TITLE Datasheet GT3-Series Lens			
CHECKED BY t k		DATE 07.01.2010		SIZE A4	DRAWING NUMBER -	REV 1	
DESIGNED BY hh		DATE 07.01.2010		SCALE 2:1	WEIGHT (g)	SHEET 1/1	

Ledil Oy C10891_GT3-XP-S C10891_GT3-XP-S / LDC (Linear)

Luminaire: Ledil Oy C10891_GT3-XP-S C10891_GT3-XP-S
Lamps: 3 x Cree XP-E (White)

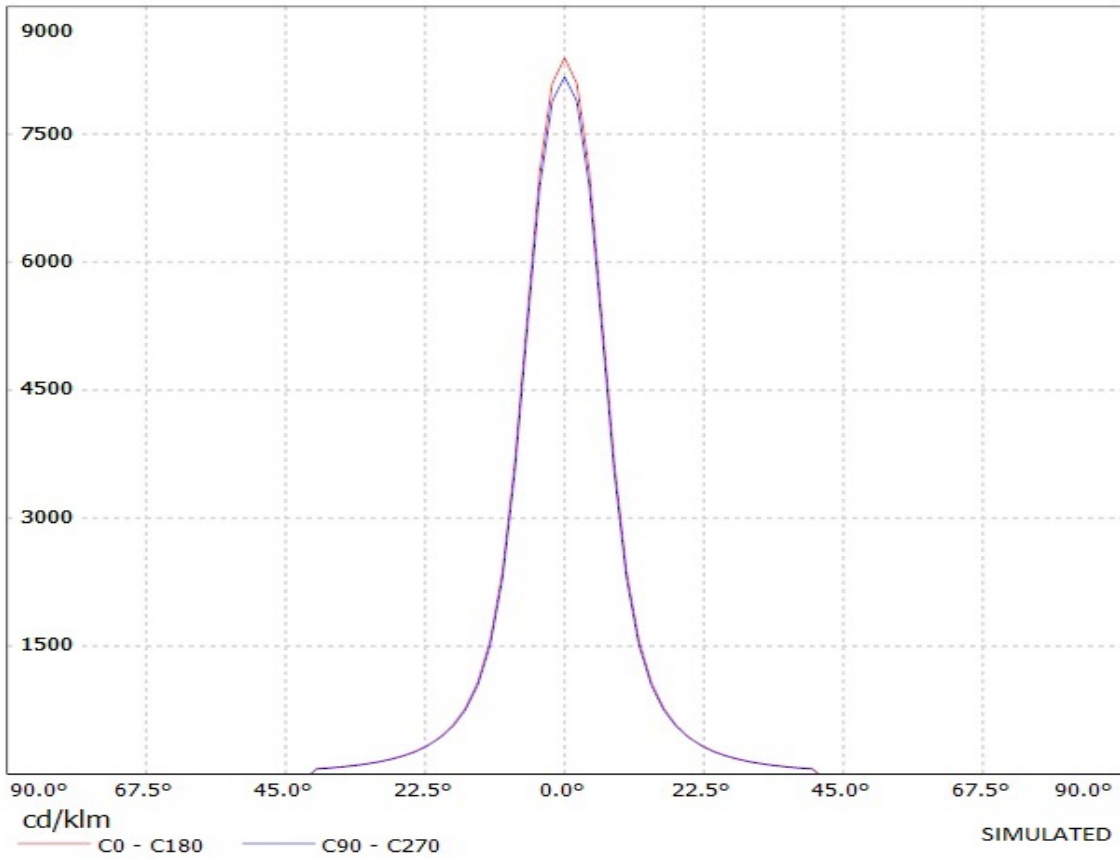

Ledil Oy C10891_GT3-XP-G-S C10891_GT3-XP-G-s / LDC (Linear)

Luminaire: Ledil Oy C10891_GT3-XP-G-S C10891_GT3-XP-G-S
Lamps: 3 x Cree XP-G (White)

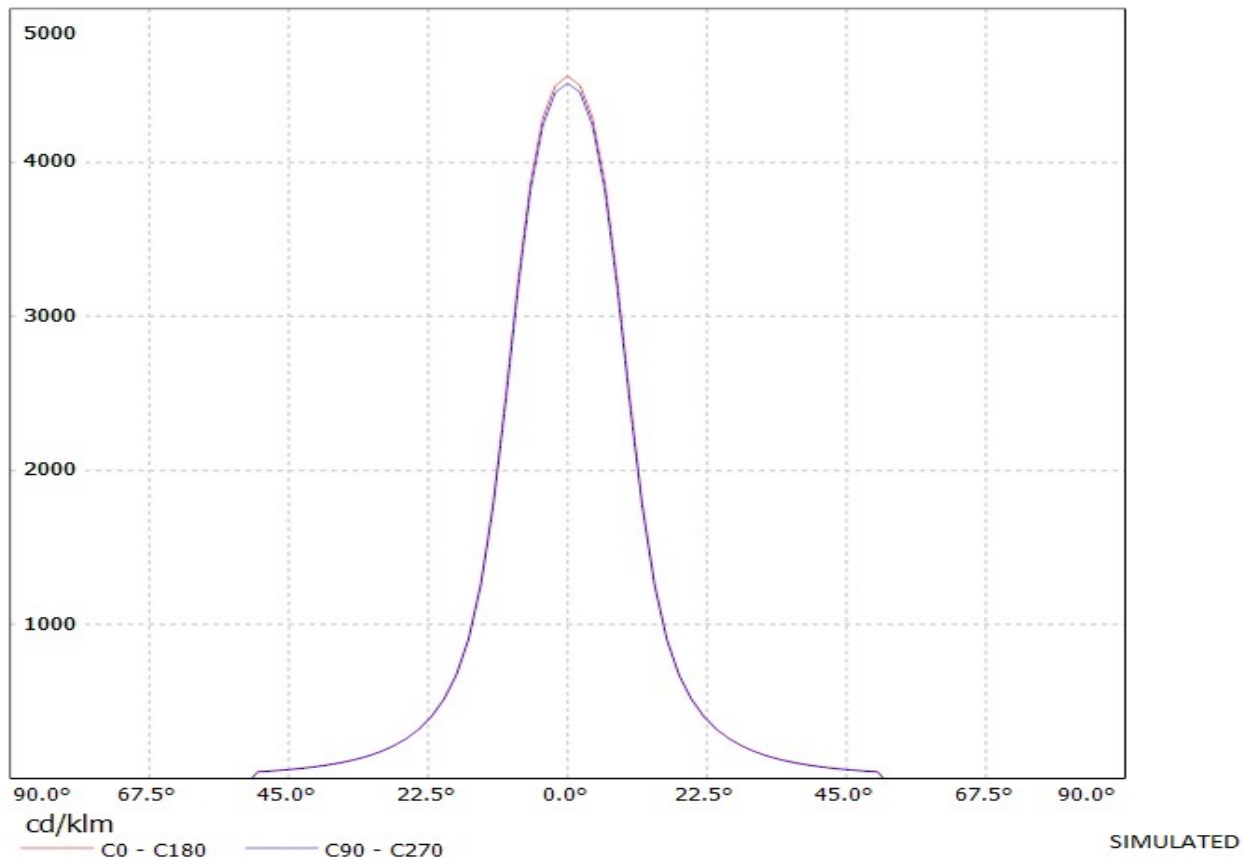

Luminaire: Ledil Oy C10891_GT3-S-OSL150 (Osram Oslon 150 deg 266lm @ 250mA)
Lamps: 1 x Osram Oslon 150 deg 266lm @ 250mA

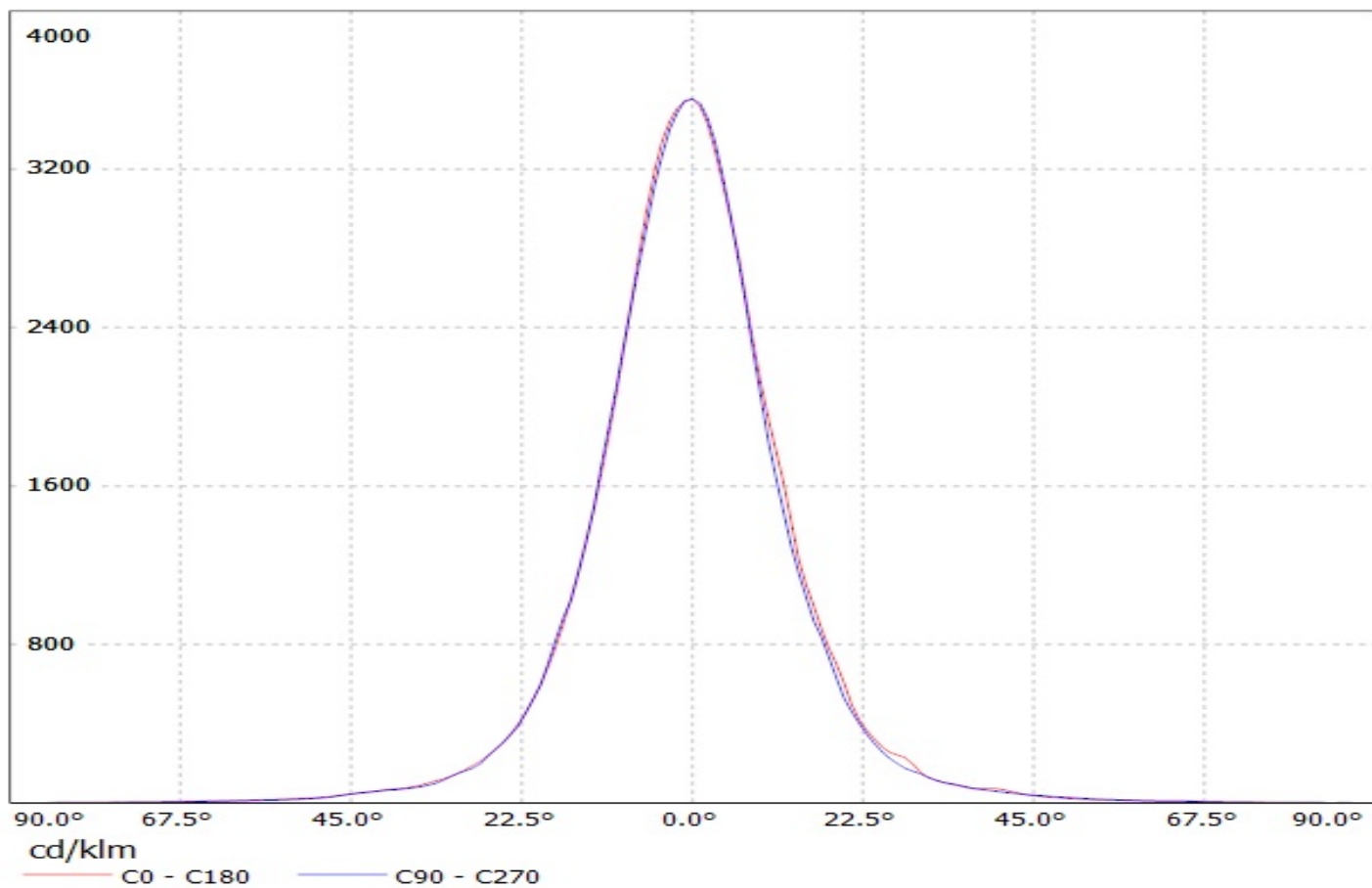

Ledil Oy C10891_GT3-XP-S C10891_GT3-XP-S / LDC (Polar)

Luminaire: Ledil Oy C10891_GT3-XP-S C10891_GT3-XP-S
Lamps: 3 x Cree XP-E (White)

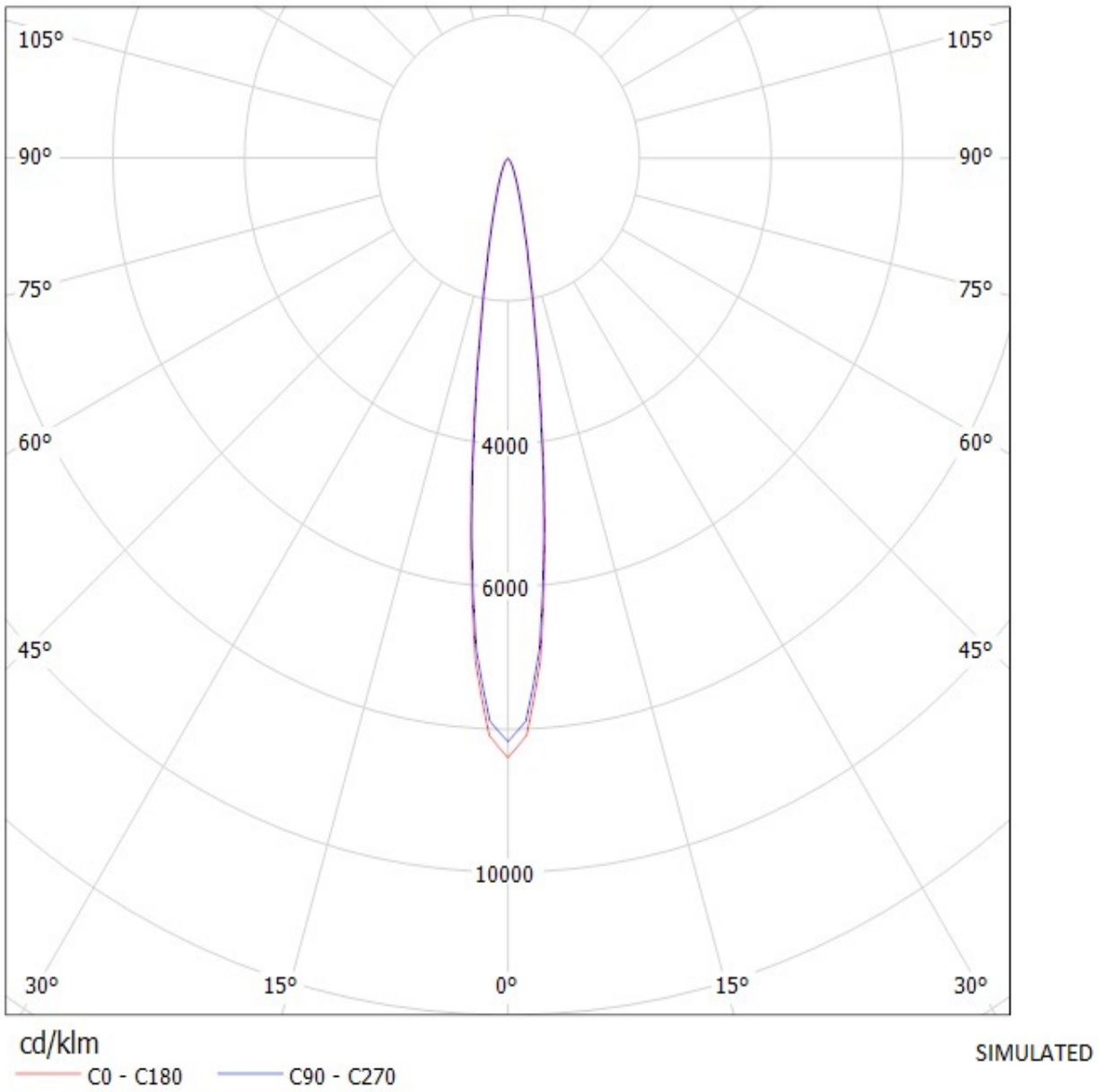

Ledil Oy C10891_GT3-XP-G-S C10891_GT3-XP-G-S / LDC (Polar)

Luminaire: Ledil Oy C10891_GT3-XP-G-S C10891_GT3-XP-G-S

Lamps: 3 x Cree XP-G (White)

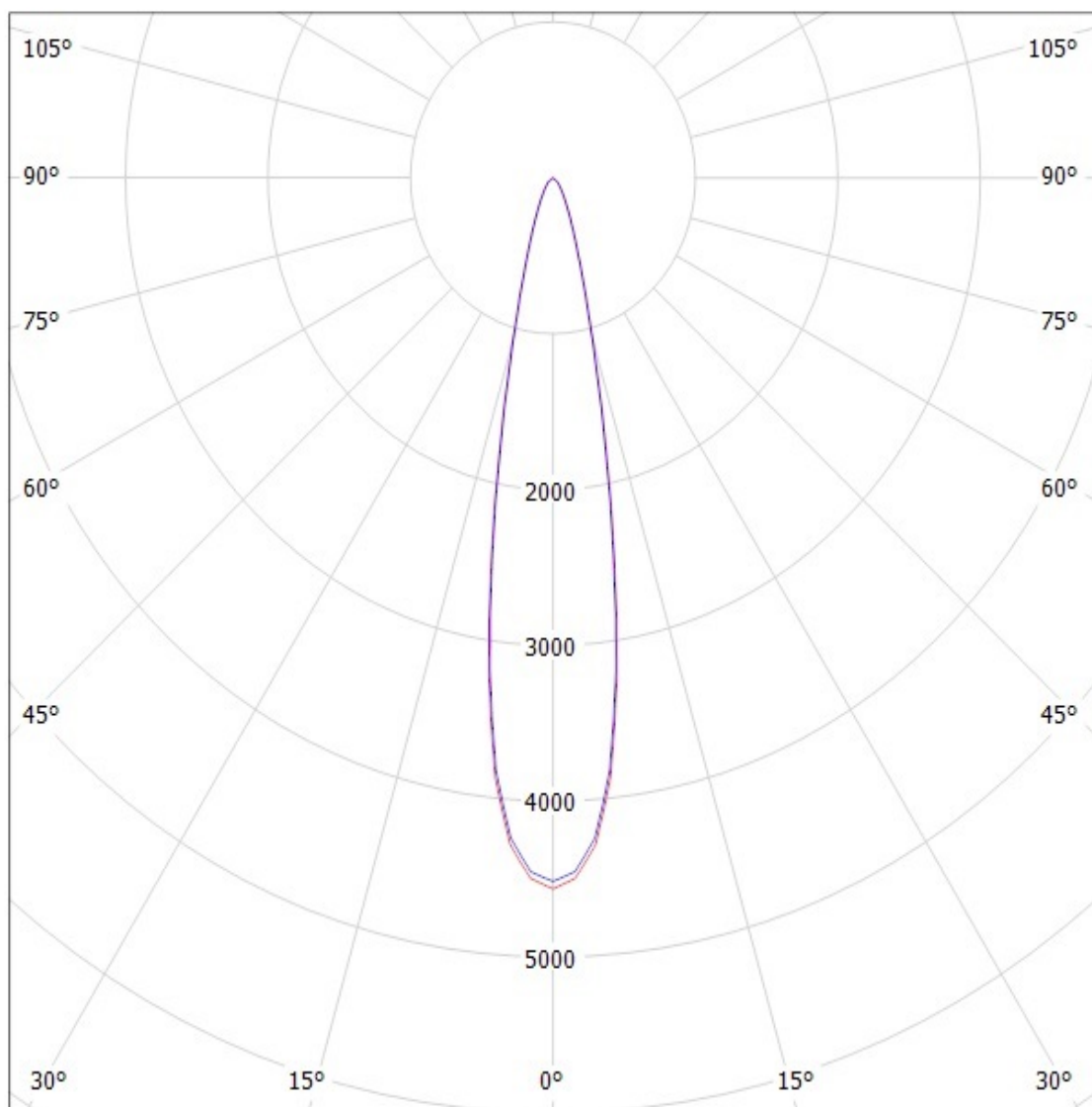

cd/klm

— C0 - C180

— C90 - C270

SIMULATED

Luminaire: Ledil Oy C10891_GT3-S-OSL150 (Osram Oslon 150 deg 266lm @ 250mA)

Lamps: 1 x Osram Oslon 150 deg 266lm @ 250mA

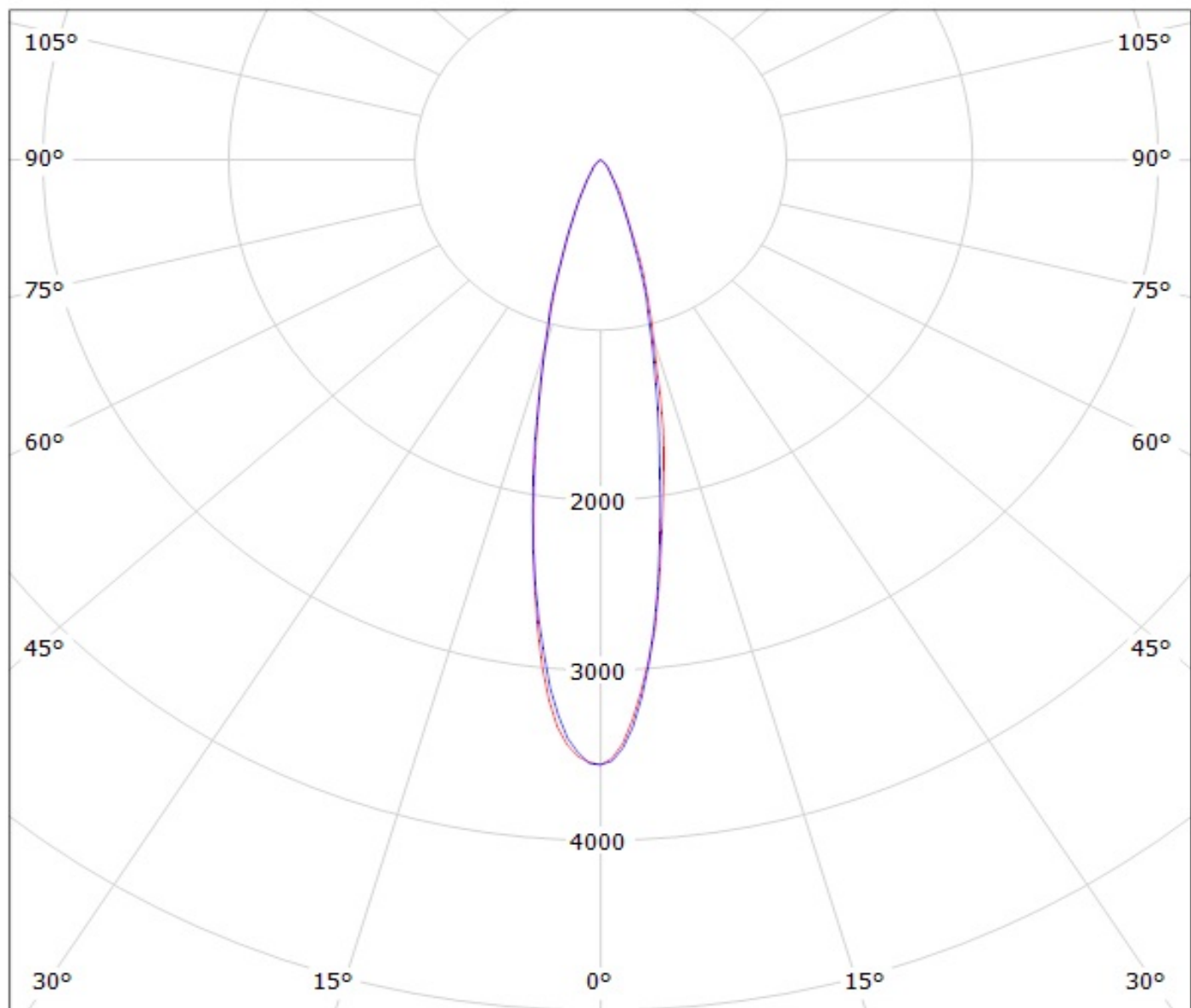

cd/klm

— C0 - C180

— C90 - C270

NOTE: The typical divergence will be changed by different color, chip size and chip position tolerance. The typical total divergence is the full angle measured where the luminous intensity is half of the peak value.