

NOTES:

1.0 ELECTRICAL SPECIFICATIONS:

1.1 FREQUENCY RANGE: DC to 26.5 GHz

1.2 MAXIMUM VSWR:

DC to 18.0 GHz: 1.12:1

18.0 to 26.5 GHz; 1.18:1

1.3 MAXIMUM INPUT POWER: 2 WATTS AT +25°C DERATED LINEARLY TO 1 WATT AT +125°C.

1.4 OPERATING TEMP. RANGE: -65°C to +125°C

2.0 MARKING (MARK UNIT AS SHOWN):

(REF.: INK-02639-27-10)

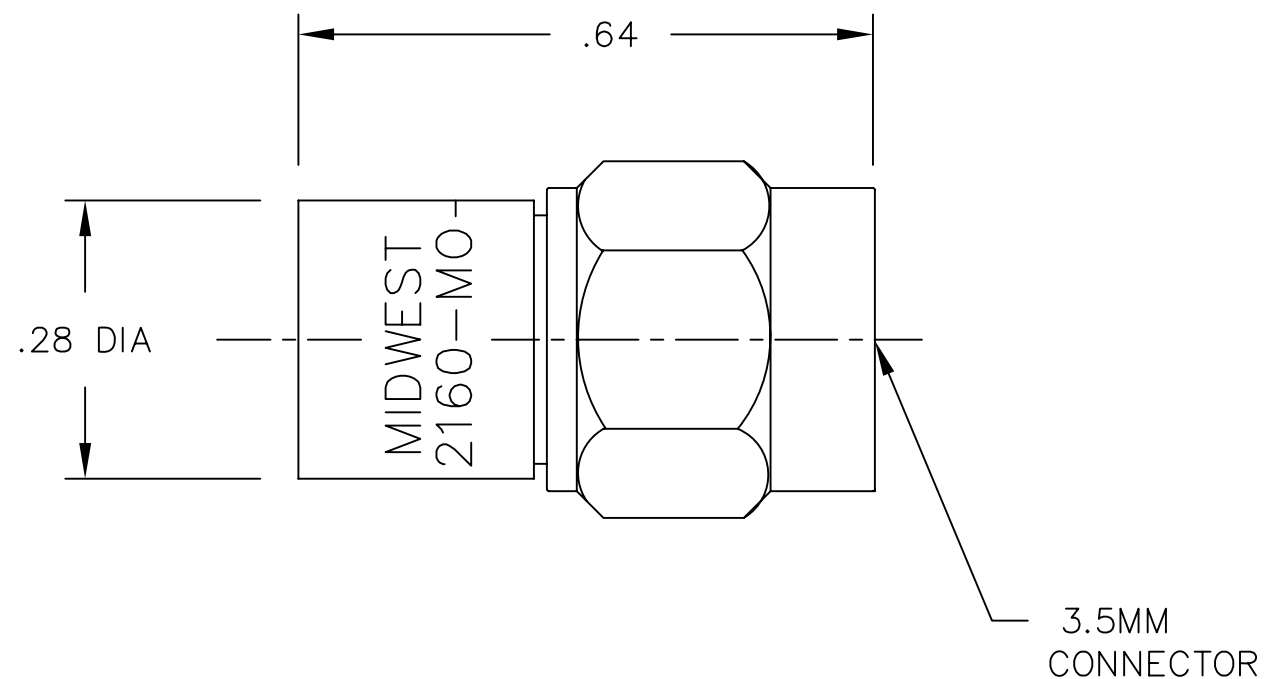

DWG NO. WAS: 06612-01-00

MODEL NUMBER	TRM-2160-MO-35M-02
REV.	E1

REV.	DESCRIPTION	DATE
-	RELEASED	2/26/86
A	ECR 4962	11/6/86
B	ECR 6545	8/1/89
C	ECR 6933	8/1/89
C1	UPDATE DWG NO.	5/17/91
D	ECN 11825	5/18/92
E	ECN 11948	8/6/92
E1	ADDED TITLEBLOCK	11/9/05

UNLESS OTHERWISE NOTED DIMENSIONS ARE IN INCHES AND TOLERANCES ARE: 3 PLACE DECIMALS ±.005 2 PLACE DECIMALS ±.02 FRACTIONS ±1/64 PARALLELITY: T.I.R. _____ FLATNESS: T.I.R. _____ CONCENTRICITY: T.I.R. _____ ANGLES AND PERPENDICULARITY: ±1'	FSCM NO.	34078 MIDWEST MICROWAVE	
	NOTICE: The information contained in this drawing is proprietary and must not be used without the permission of Midwest Microwave		TITLE TERMINATION
	DRAWN/DATE A.BEATTY 5/18/92	ENG./DATE G.KOZAK 5/19/92	DRAWING NUMBER TRM-2160-MO-35M-02
	CHECKED/DATE M.HOLLMAN 5/18/92	APPROVED/DATE	SCALE: 5=1 SHEET 1 of 1