

# Datamate J-Tek Connectors

## Female Vertical Surface Mount Reverse Fix

- Fully shrouded contacts.
- Polarised mouldings.
- Includes Board Mount fixing.
- Mates with male Datamate J-Tek connectors with compatible Reverse Fix jackscrews.



### REVERSE FIX

### CALCULATION

<b>A</b>	B + 12
<b>B</b>	Total no. of contacts - 2
<b>C</b>	B + 7

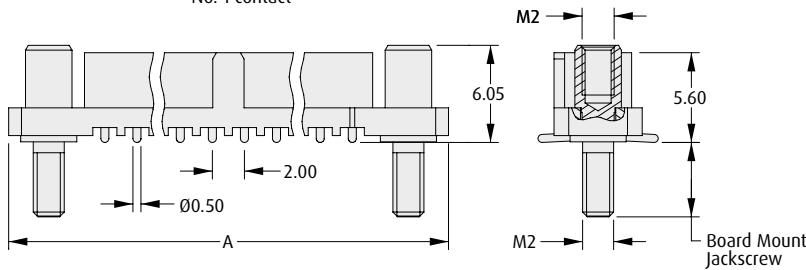
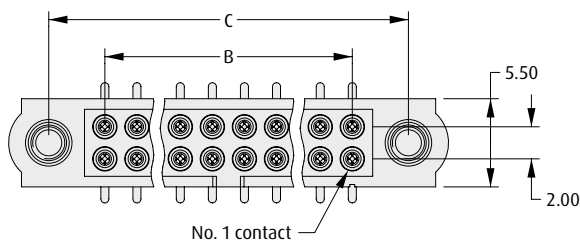

### Board Mount Nut, 2 per connector

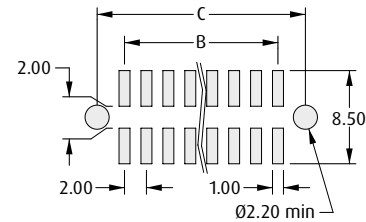
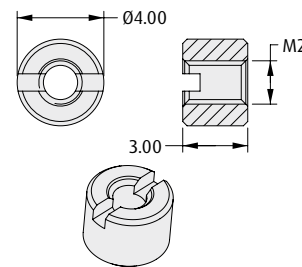

Recommended PC Board Pattern

### HOW TO ORDER

**M80 - 4S1 XX XX FX**

**SERIES CODE**

**TOTAL NO. OF CONTACTS**

**04, 06, 08, 10, 12, 14, 20, 26, 34, 42, 50**

### TYPE

<b>F8</b>	3.5mm Board Mount Jackscrew
<b>F9</b>	5mm Board Mount Jackscrew

### FINISH

<b>05</b>	Gold
<b>42</b>	Gold + Tin

All dimensions in mm.